



MASTERPIECES
MADE IN GERMANY

Flow Limiting

BF

H₂O



OVERVIEW

Operation

- Mechanical flow limiter

Application

- Water treatment
- Irrigation
- Sanitary installations

Features

- Universal orientation
- High reliability
- No power supply required
- Suitable for hot water
- Threaded connection

Installation information

- The operating instructions for BF must be observed!
- **Download: www.meister-flow.com**

BF 1 0003 12-15 EM

OPERATING DATA

Control pressure	2 - 10 bar
Operating pressure, max.	10 bar
Temperature, max.	200 °C
Measuring accuracy	up to 2 l/min ± 15 %
	of nominal value
	at 3 l/min and higher ± 10 %
	of nominal value

FLOW

Type	Flow for H ₂ O at 20 °C	
	Q _{min} l/min	Q _{max} l/min
BF [DN 40]	2	60
BF [DN 50]	4	120
BF [DN 65]	7	210
BF [DN 80]	9	270
BF [DN 100]	14	420

MATERIALS

Stainless steel version, wetted parts

Device body:	1.4571
Regulating star:	1.4310
Cone:	1.4301
Rivet:	1.4301
Retaining ring:	1.4122

■ TECHNICAL DRAWING

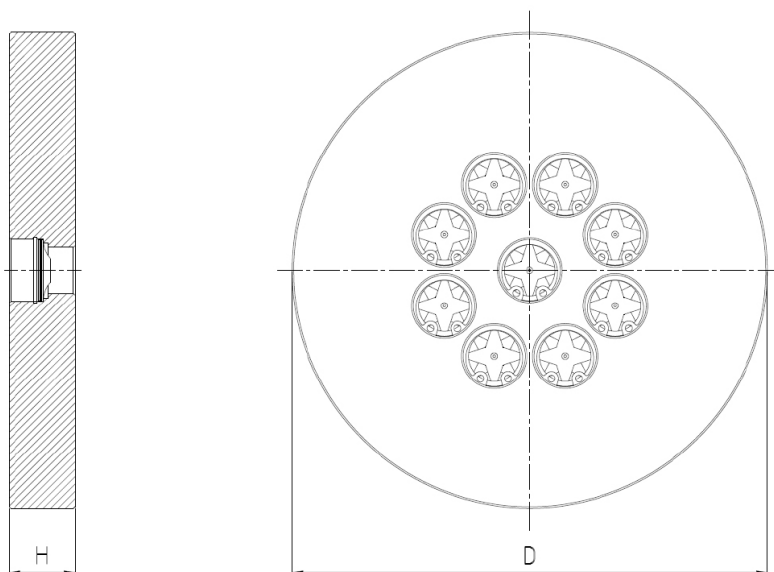

■ SUMMARY OF TYPES

Type	Overall dimensions [mm]		Number of Regulating stars	Pressure rating Device body	Flow [l/min]		H [mm]	D [mm]
	Nennweite	Standard			min.	max.		
BF	DN 40	DIN / ASME	2	PN 16 / 300 lbs	2	60	19,1	95
BF	DN 50	DIN	4	PN 16	4	120	18,0	110
BF	DN 50	ASME	4	300 lbs	4	120	23,9	113
BF	DN 65	DIN / ASME	7	PN 16 / 300 lbs	7	210	23,9	130
BF	DN 80	DIN	9	PN 16	9	270	20,0	145
BF	DN 80	ASME	9	300 lbs	9	270	23,9	150
BF	DN 100	DIN	14	PN 16	14	420	20,0	165
BF	DN 100	ASME	14	300 lbs	14	420	23,9	182

Proudly Distributed By

TRIDENT AUSTRALIA
FLUID SYSTEMS & COMPONENTS



MASTERPIECES
MADE IN GERMANY

BF 4 0001 12-15 E M

Meister Strömungstechnik GmbH • Im Gewerbegebiet 2 • 63831 Wiesen / Germany
Tel. +49 (0) 6096 9720-0 • Fax +49 (0) 6096 9720-30 • sales@meister-flow.com • www.meister-flow.com
The general business terms of Meister Strömungstechnik GmbH are valid • All rights reserved



Ph: +61 8 9456 1300

Web: www.tridentaustralia.com.au

Email: sales@tridentaustralia.com.au